



2025.08

# DRESSPACK SYSTEM FOR ROBOT

MRS - MULTIFLEX RETRACTION SYSTEM

 **brevetti  
stendaito**  
ENERGY IN MOTION

## BREVETTI STENDALTO

**Brevetti Stendalto was born in 1968 out of Giovanni Mauri's brilliant intuition that dynamic cable and hose protection would soon become paramount in machinery industry.** He designed and marketed a cable chain made of nylon, much more lightweight, functional and cost-effective than traditional steel chains.

**Since the beginning, Brevetti Stendalto has fostered innovation in products through big investments in Research and Development.** The desire to meet, or rather anticipate, market needs has inspired Brevetti's constant evolution over more than 50 years, with an ever-increasing range of products.

**Technology, innovation and evolution have always been the bywords of a company that started out as a small family business and rapidly evolved into a multi-national group with six branch offices and more than 130 employees worldwide.** Markets such as industrial robotics, material working machines, automatic warehouses, port cranes and offshore cannot do without Brevetti Stendalto cable chains.

Still to these days Giovanni Mauri, with his daughter Laura and his son Claudio, **leads a company that has developed an important partnership with customers and has been able to maintain a serene and productive work environment,** based on trust and motivation among people.





# Cable routing from axis 1 to axis 7

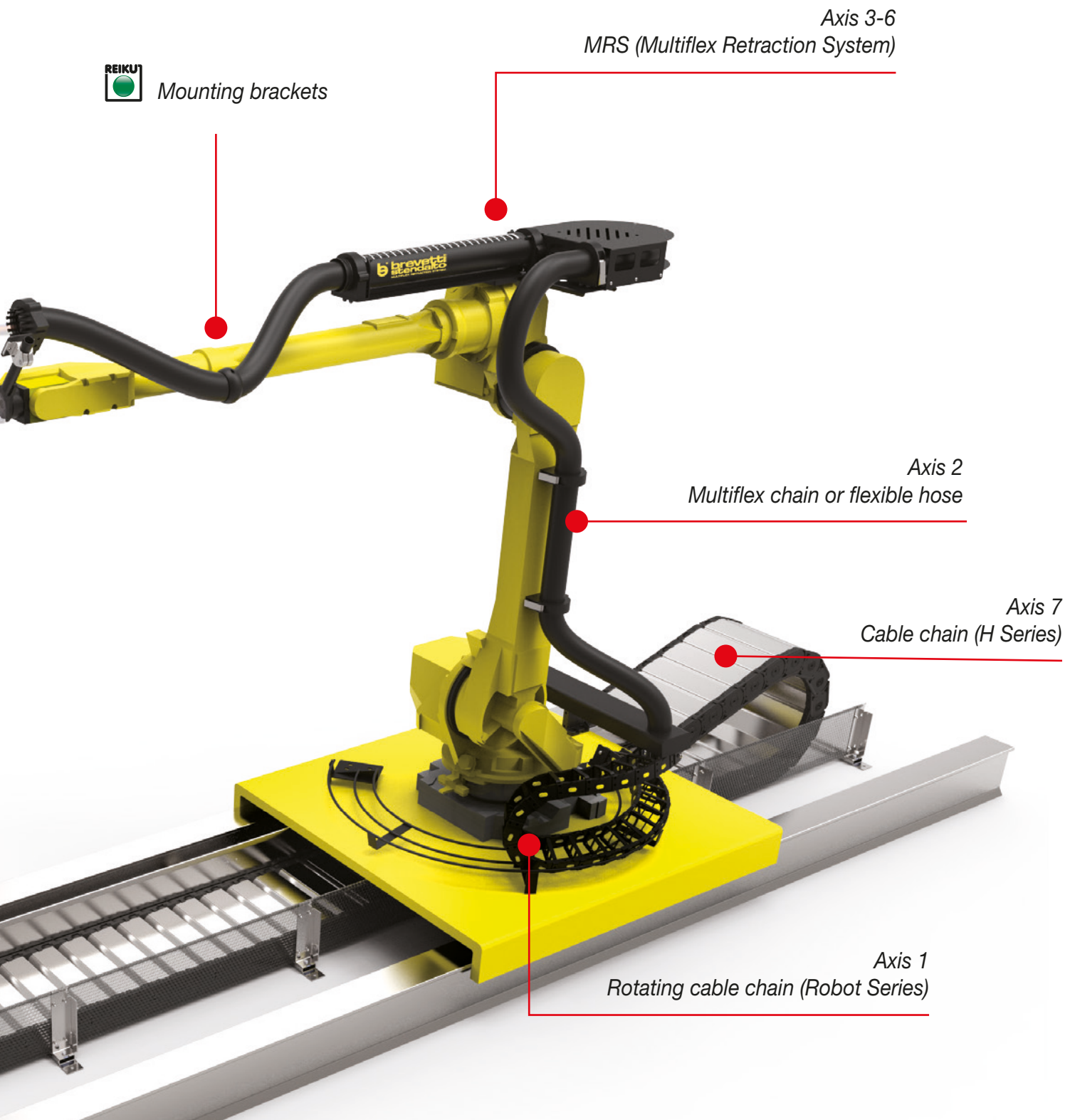

# Serie Robot

## MFC65100

### MULTIFLEX chain for 3D movements with opening frames

Chain for multi-axis movement, for application on robots and new-generation work centers, fully-enclosed, with opening frames.

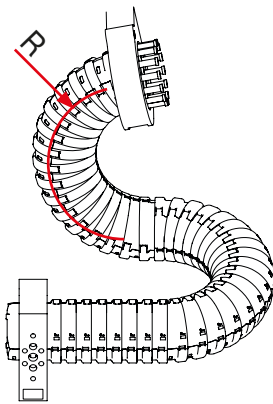
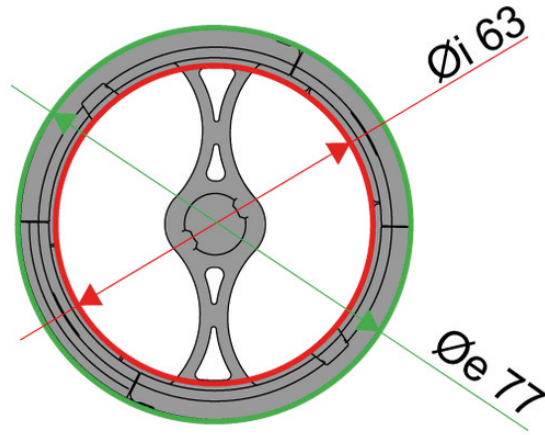

Inner diameter mm	Outer diameter mm	Minimum bend radius mm	Pitch mm	No. of links per meter	Weight kg/m	Torsion per meter	Lodged utilities
63	77	100	18.5	54	1.6	$\sim \pm 540^\circ$	max. $\text{Ø } 20$ mm

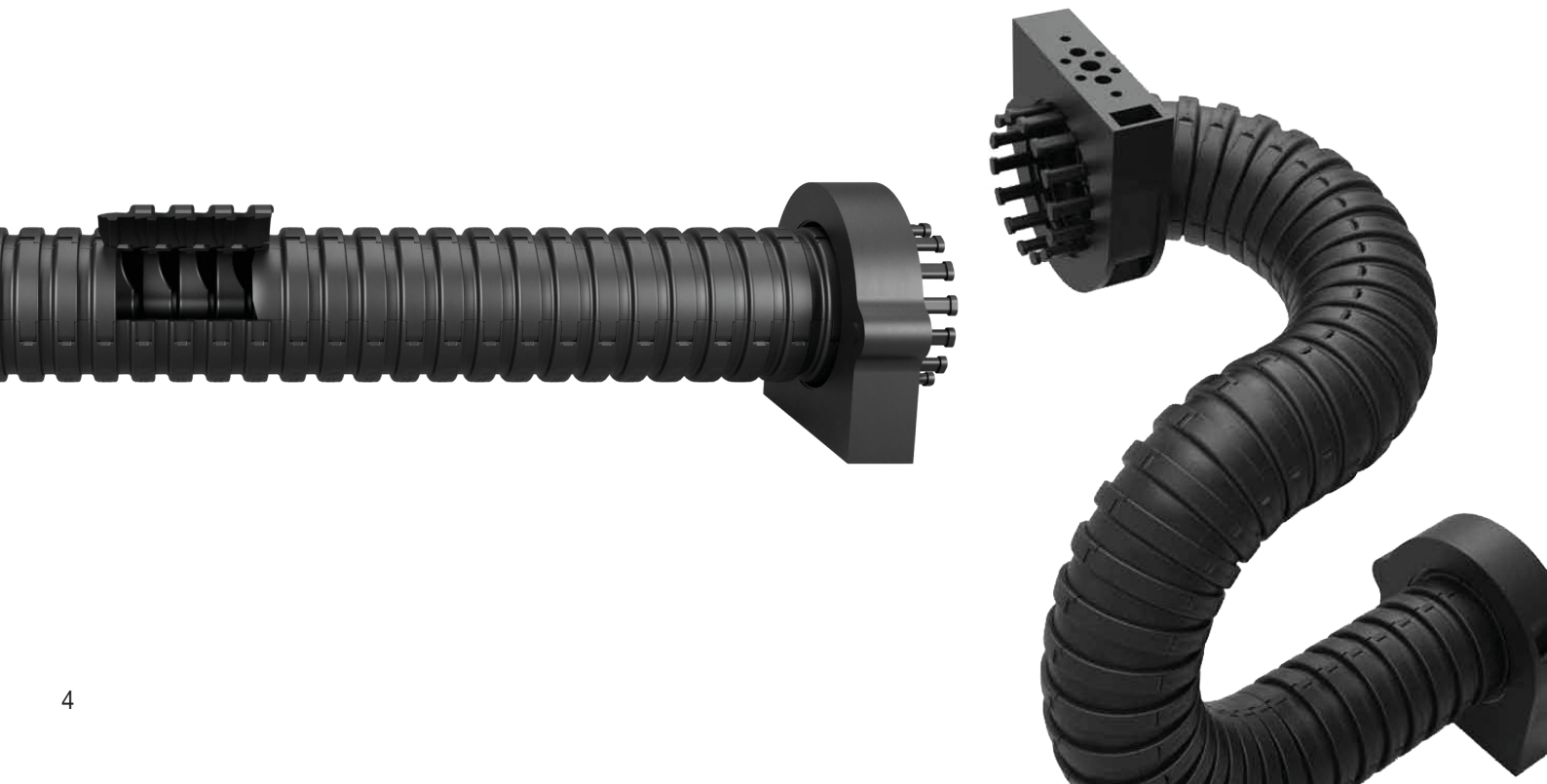
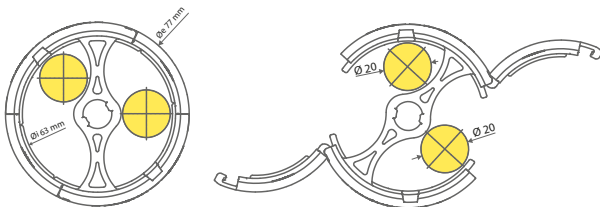

## Fixation accessories

### Fixation brackets with clamping combs

Standard bracket set with clamping combs.  
This product is used at the extremities of MULTIFLEX chain.

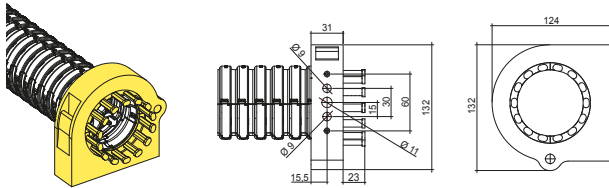

Type of latch	Part No.
Nylon	AMF65K01
Zinc-plated steel	AMF65M01

### Fixation brackets with clamping combs Frontal fixation

Standard bracket set with clamping combs, for frontal fixation.  
This product is used at the extremities of MULTIFLEX chain.

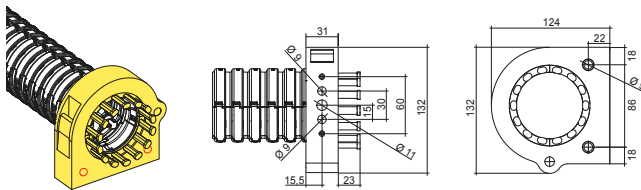

Type of latch	Part No.
Nylon	AMF65K01F
Zinc-plated steel	AMF65M01F

### End and intermediate fixation brackets

Standard bracket set without clamping combs.  
This product can be used anywhere on MULTIFLEX chain.

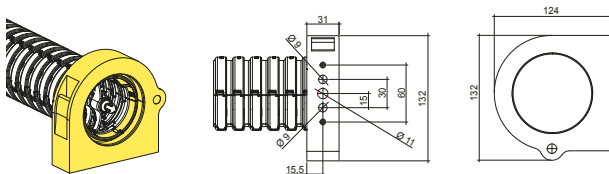

Type of latch	Part No.
Nylon	AMF65K02
Zinc-plated steel	AMF65M02

### End and intermediate fixation brackets Frontal fixation

Standard bracket set without clamping combs, for frontal fixation.  
This product can be used anywhere on MULTIFLEX chain.

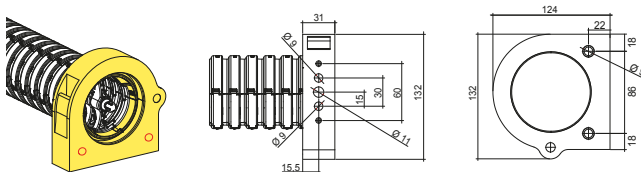

Type of latch	Part No.
Nylon	AMF65K02F
Zinc-plated steel	AMF65M02F

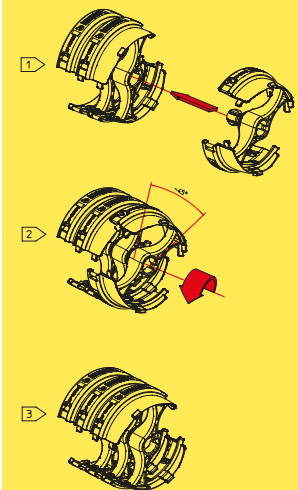

Assembly instructions

# Serie Robot

## MFC65100

### MULTIFLEX chain for 3D movements with opening frames

#### Protection and guiding accessories

##### Sliding fixation brackets

Sliding bracket set.

This product can be used anywhere on MULTIFLEX chain.

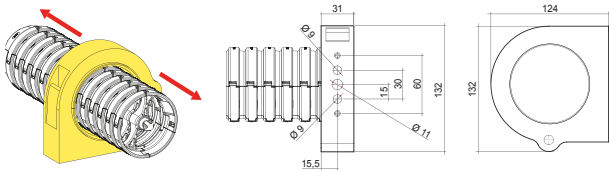

Type of latch	Part No.
Nylon	AMF65K03
Zinc-plated steel	AMF65M03

##### Sliding fixation brackets Frontal fixation

Sliding bracket set, for frontal fixation.

This product can be used anywhere on MULTIFLEX chain.

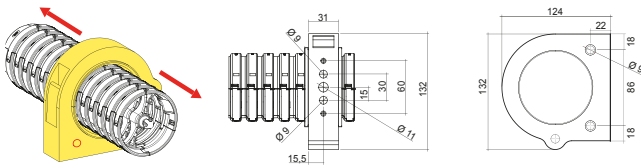

Type of latch	Part No.
Nylon	AMF65K03F
Zinc-plated steel	AMF65M03F

##### Oscillating guiding support with ring

Allows to guide passage of chain, maintaining all degrees of liberty of movement.

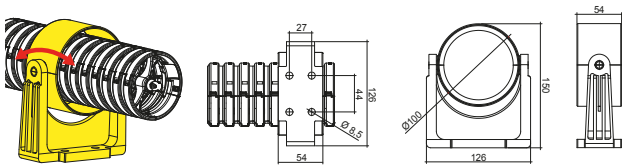

Part No.
ASO65

##### Protection ring

Bumper and rotating protection against hard shocks and extreme friction.

This product can be used anywhere on MULTIFLEX chain.

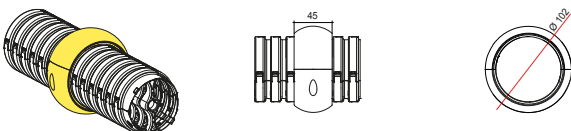

Part No.
PCM65

### Rotating base

Universal rotating flange, usable with any fixation device. Allows rotation of fixation brackets and pivoting forks.

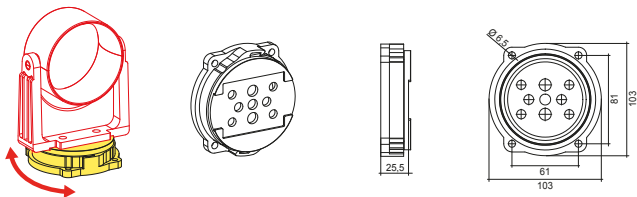

Part No.  
**PADFB-70**

### Connection jaw

Connector between MULTIFLEX chain and corrugated sheath NW70, or between chain and multi-holed rubber seal. To combine with one fixation brackets type PASSB-70K or PASSB-70M.

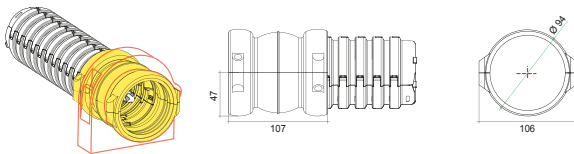

Part No.  
**PAVGB-70/8529**

### Fixation bracket

To combine with Part No. PAGB-70/8529.

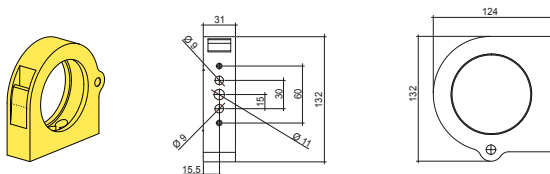

Type of latch	Part No.
Nylon	<b>PASSB-70K</b>
Zinc-plated steel	<b>PASSB-70M</b>

### Connection ring

Connector between MULTIFLEX chain and corrugated sheath NW70.

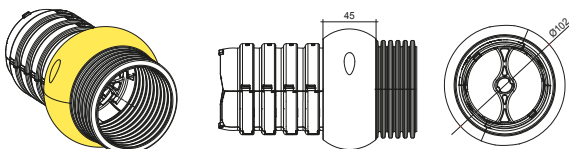

Part No.  
**GJM65**

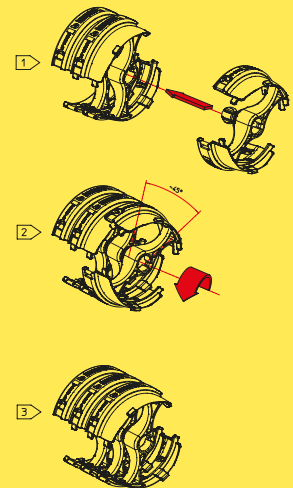

Assembly instructions

# Serie Robot

## MFC65100

### MULTIFLEX chain for 3D movements with opening frames

#### Rubber seals and end caps

##### Holed end rubber seals

Multi-hole rubber seal  $\varnothing 14$  mm (4x) -  $\varnothing 20$  mm (4x)

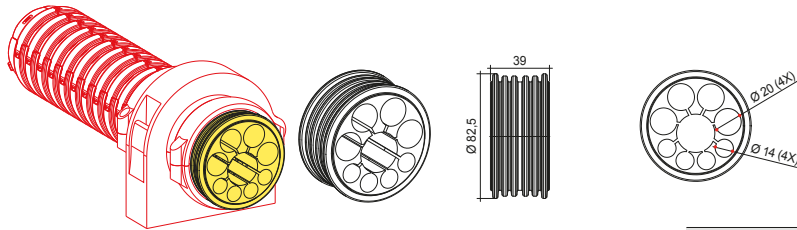

Part No.  
TKKSB-70B01

##### Holed end rubber seals

Multi-hole rubber seal  $\varnothing 7.5$  mm (1x) -  $\varnothing 10$  mm (1x) -  $\varnothing 12.5$  mm (2x) -  $\varnothing 20$  mm (4x)

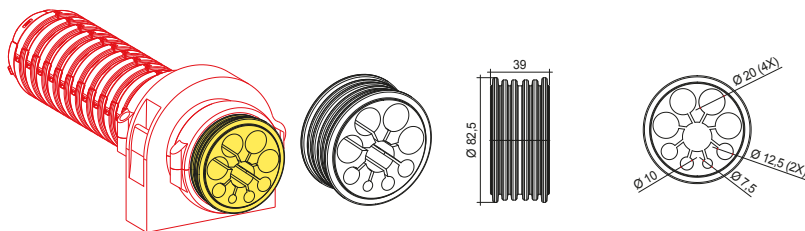

Part No.  
TKKSB-70B02

##### Holed end rubber seals

Multi-hole rubber seal  $\varnothing 12.5$  mm (1x) -  $\varnothing 14$  mm (1x) -  $\varnothing 15.5$  mm (2x) -  $\varnothing 20$  mm (3x)

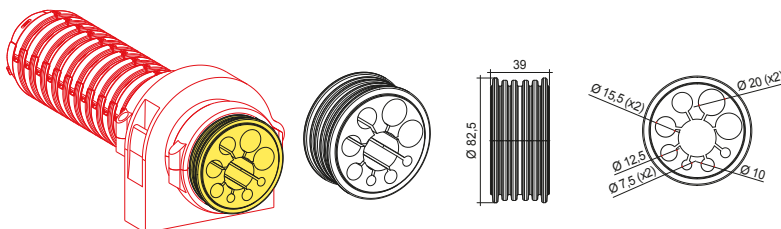

Part No.  
TKKSB-70B03

**Holed end rubber seals**

Multi-hole rubber seal Ø 7.5 mm (2x) - Ø 10 mm (1x) - Ø 12.5 mm (1x) - Ø 15.5 mm (1x) - Ø 20 mm (2x)

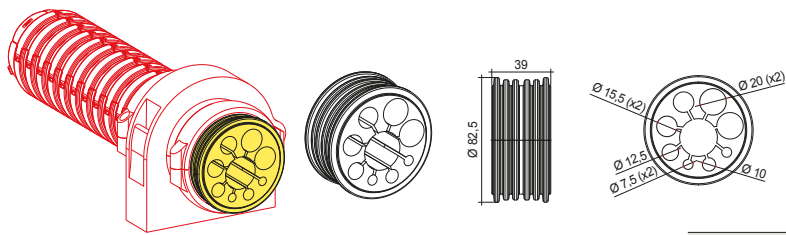

**Part No.**  
**TKKSB-70B04**

**Holed end rubber seals**

Multi-hole rubber seal Ø 12.5 mm (1x) - Ø 14 mm (2x) - Ø 17 mm (1x) - Ø 18 mm (3x) - Ø 19 mm (1x)

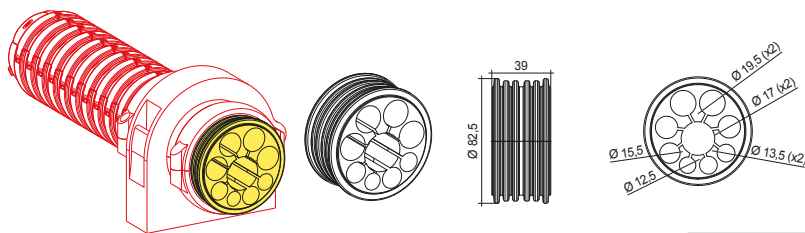

**Part No.**  
**TKKSB-70B05**

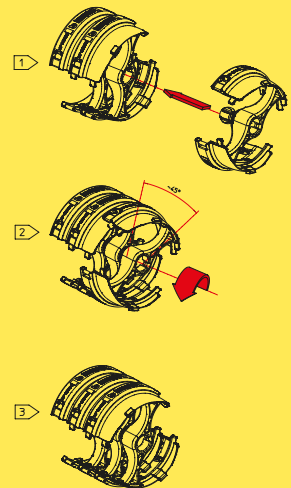

**Assembly instructions**

# Serie Robot

## MFC65100

### MULTIFLEX chain for 3D movements with opening frames

#### Holed end rubber seals

Multi-hole rubber seal  $\varnothing$  12.5 mm (1x) -  $\varnothing$  15.5 mm (2x) -  $\varnothing$  14 mm (1x) -  $\varnothing$  20 mm (4x)

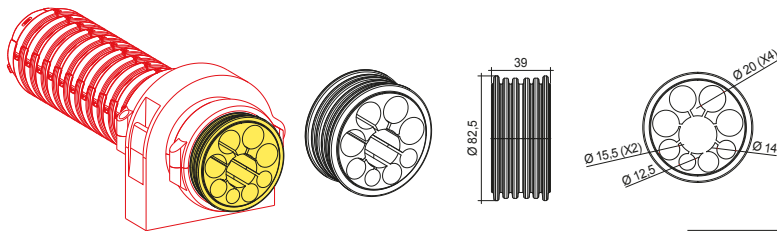

Part No.  
TKKSB-70B07

#### Blind end rubber seal

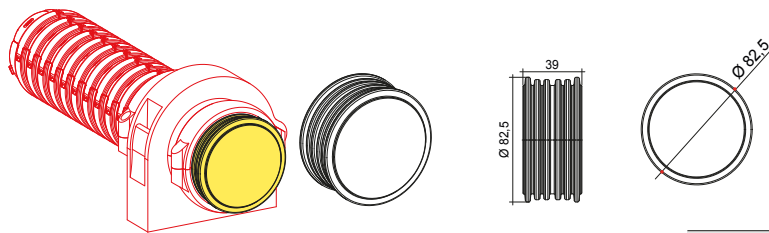

Part No.  
TKKSB70BLIND

#### End caps

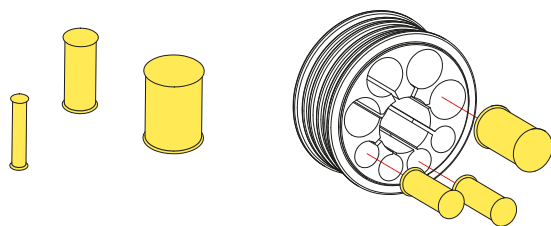

Part No.	Cap $\varnothing$	Item No.
	$\varnothing$ 10 mm	TKBSB-10
	$\varnothing$ 12.5 mm	TKBSB-12.5
	$\varnothing$ 14 mm	TKBSB-14
	$\varnothing$ 15.5 mm	TKBSB-15.5
	$\varnothing$ 19.5 mm	TKBSB-19.5

## Kevlar protective coat

### Non-opening Kevlar protective coat for dynamic applications

Coat made of Kevlar aramidic fiber on one side; the other side features an aluminum layer in relief that covers the outer surface and reflects up to 95% of I thermal radiations.

Protects against weld spurts up to 540 °C.

Kevlar tissue offers good resistance to oils, greases, acids, bases, and solvents in low concentration.

The reflecting surface offers good resistance to UV rays as well.

#### Technical data

Thickness: 0.35 mm

Specific weight: 1.44 / 1.45 g/cm<sup>3</sup>

Pulling resistance: 2500 N/50 mm

Flammability: non-flammable (up to DIN 4102B1)

Part No.	Item No.
500 mm	<b>KA04S08005</b>
1000 mm	<b>KA04S08010</b>
1500 mm	<b>KA04S08015</b>
2000 mm	<b>KA04S08020</b>

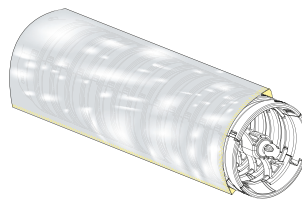

### Velcro opening Kevlar protective coat for static applications

Coat made of Kevlar aramidic fiber on one side; the other side features an aluminum layer in relief that covers the outer surface and reflects up to 95% of I thermal radiations.

Protects against weld spurts up to 540 °C.

Kevlar tissue offers good resistance to oils, greases, acids, bases, and solvents in low concentration.

The reflecting surface offers good resistance to UV rays as well.

#### Technical data

Thickness: 0.35 mm

Specific weight: 1.44 / 1.45 g/cm<sup>3</sup>

Pulling resistance: 2500 N/50 mm

Flammability: non-flammable (up to DIN 4102B1)

Part No.	Item No.
500 mm	<b>KA04S080G05</b>
1000 mm	<b>KA04S080G10</b>
1500 mm	<b>KA04S080G15</b>
2000 mm	<b>KA04S080G20</b>

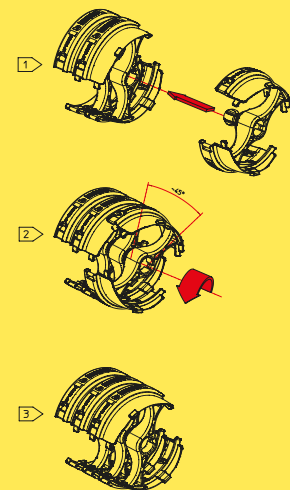
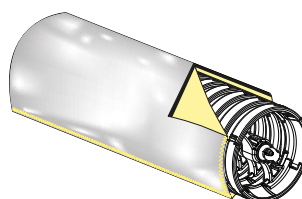

Assembly instructions

# Serie Robot

## MRS

### Dresspack system for robot

Spring-driven retraction dresspack system for industrial robots that features 3D chain MULTIFLEX or polyamide conduits, accessories, and specific installation brackets.

Multiflex Retraction System	Multiflex or Conduits	Dimension	Left or Right
MRS	□	□□	□

Part Number composed as follows:  
e.g. **MRS M 65 R**

**(M)** Multiflex  
**(C)** Conduits

Multiflex  
**65**

**(L)** Left  
**(R)** Right

Conduits  
Ø 29  
Ø 36  
Ø 52  
Ø 70

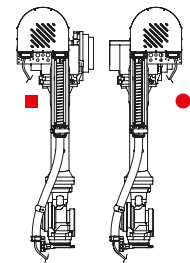
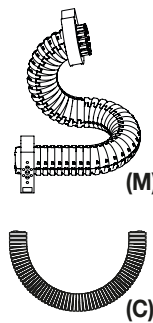

■ Left routing of utilities at the fixed end  
● Right routing of utilities at the fixed end



**Available sizes**

*Serie Robot*

**MRS**  
MULTIFLEX RETRACTION SYSTEM

**MRSC29**

Dresspack with corrugated conduits NW29



**MRSC36**

Dresspack with corrugated conduits NW36



**MRSC52\***

Dresspack with corrugated conduits NW52



**MRSC70\***

Dresspack with corrugated conduits NW70



**MRSM65\***

Dresspack with Multiflex chain MFC65100



\*Caseless version available

# Serie Robot

# MRS

## Dresspack system for robot

### Installation Brackets for MRS C29 / C36

For all widely used drill pattern, custom solution on request.

	Part number	Robot OEM	Robot model	Weight kg
	SAMRS10.001	FANUC	M70iC50 M70iC70	1.3
	SAMRS10.002	FANUC	R-2000iC R-2000iB R-2000iA S430	0.4
	SAMRS10.003	KUKA	KR12 KR16 KR20_R1810	0.6
	SAMRS10.004	ABB	IRB2600	2.6
	SAMRS20.004	ABB	IRB6640 IRB6700 IRB6660 IRB8700 IRB6650S IRB720	2.4
	SAMRS10.005	ABB	IRB1600	2.4
	SAMRS20.005	ABB	IRB4600	3.1
	SAMRS30.003	ABB	IRB6620	1.9
	SAMRS20.007	KUKA	KR240_R3330 KR340_R3330 KR420 KR210 KR3100 ultra KR120 pro KR90 KR40PA KR150	2.4
	SAMRS10.006	FANUC	M-10iA M-20iA/20M M-20iA/35M M-20iB/25 M-16iB/20	0.35

	Part number	Robot OEM	Robot model	Weight kg
	SAMRS10.007	FANUC	M-900iB / 280L M-900iB / 330L R1000iA/80F R2000i C/270F	0.8
	SAMRS10.011	EPSON	C8-A1401S	0.3
	SAMRS10.008	COMAU	NS-16	0.4
	SAMRS10.009	KAWASAKI	RS30N / 50N / 80N	1.1
	SAMRS20.002	COMAU	NJ-165 NJ-110 NJ-40 NJ-16 NJ-130 NJ-60 NJ-230	2.0
	SAMRS10.012	YASKAWA	GP180 GP200R GP225	0.7
	SAMRS20.011	ABB	IRB2400_m2000	1.6
	SAMRS20.009	FANUC	M70iC20L M20iA M20iC M20iD	1.7
	SAMRS10.013	KUKA	KR20_R3100 KR50 KR70	2.1
	SAMRS10.014	DENSO	VM60B1 /-V/RC8A	0.4
	SAMRS10.015	HYUNDAI	HH020	0.6
	SAMRS10.016	ABB	IRB260	1.4
	SAMRS10.017	ABB	IRB7600	1.0
	SAMRS10.018	STAUBLI	RX130-L	0.7

Brackets for robots not listed may be manufactured upon request

Serie Robot

**MRS**  
MULTIFLEX RETRACTION SYSTEM

# Serie Robot

# MRS

## Dresspack system for robot

### Installation Brackets for MRS C52 / M65 / C70

For all widely used drill pattern, custom solution on request.

	Part number	Robot OEM	Robot model	Weight kg
	SAMRS30.001	FANUC	R-2000iC100P R-2000iC125L R-2000iC165F/210F R-2000iB R-2000iA S430	2.2
		YASKAWA	MH225 MPL100 II GP180	
	SAMRS30.007	FANUC	R-1000iA	2.5
	SAMRS30.006	FANUC	R-2000iC210L	2.7
	SAMRS10.001	FANUC	M70iC50 M70iC70	1.3
	SAMRS10.005	ABB	IRB1600	2.4
(Not required)	-	YASKAWA	HP20	-
	SAMRS10.004	ABB	IRB2600	2.6
	SAMRS20.005	ABB	IRB4600	3.1
	SAMRS20.006	HYUNDAI	HS 200 HX400	0.2
	SAMRS20.012	HYUNDAI	HS160L HS180 HS200 HS220	0.2
	SAMRS20.007	KUKA	KR240_R3330 KR340_R3330 KR3100 ultra KR120 pro KR420 KR90 KR150 KR420 KR40PA	2.4
	SAMRS20.008	FANUC	M-900iB/700	2.8

	Part number	Robot OEM	Robot model	Weight Kg
	SAMRS30.002	FANUC	M-900iB/360	2.4
	SAMRS20.004	ABB	IRB6640 IRB6700 IRB6710 IRB6660 IRB8700 IRB6650S IRB6720	2.4
	SAMRS30.003	ABB	IRB6620	1.9
	SAMRS30.004	FANUC	M-900iA/400L M-900iB/400L M-900iB/280L M-900iB/330L	3.0
		YASKAWA	GP400	
	SAMRS30.005	KUKA	KR160	1.1
	SAMRS30.008	YASKAWA	GA50	2.2
	SAMRS30.009	FANUC	M-2000iA900L	3.1
	SAMRS30.010	EFORT	ER150-3200 ER210-2700	2.8
	SAMRS20.003	KAWASAKI	ZX300S ZX165U	2.9
	SAMRS20.002	COMAU	NJ-165 NJ-110 NJ-40 NJ-16 NJ-130 NJ-60 NJ-290	2.0
	SAMRS20.009	FANUC	M70iC20L M20iA M20iC M20iD	1.7
	SAMRS10.009	KAWASAKI	RS30N / 50N / 80N RS015X	1.1
		MITSUBISHI	RY-355080FR	
	SAMRS20.010	ABB	IRB7600-400	2.7
	SAMRS20.011	ABB	IRB2400_m2000	1.6
	SAMRS10.013	KUKA	KR50 KR70	2.1

Brackets for robots not listed may be manufactured upon request

# Serie Robot

# MRS

## Dresspack system for robot

### Brackets for axis no. 6 (Tennis Racket)

Part number	Robot model	With recess	A (Ø)	B (Ø)	Weight (KG)
TRMRS00.001	COMAU NJ-165	no	102	/	2.9
TRMRS00.002	FANUC R-2000iB	yes	165	160	2.6
	FANUC R-2000iA				
	FANUC R-2000iC/125L				
	FANUC M-410iC				
	KAWASAKI ZX165U				
TRMRS00.003	FANUC M-900iB/700	no	275	/	3.7
TRMRS00.004	FANUC M-900iB/360	no	220	/	2.9
	FANUC M-900iB/280L				
	KUKA KR420				
TRMRS00.005	ABB IRB 2400	yes	80	63	1.2
	ABB IRB 2600				
	ABB IRB 4600 20				
	KUKA KR20				
TRMRS00.006	FANUC M-710iC 45/50/70	no	124	/	2
TRMRS00.007	FANUC M-710iC 20L	yes	80	50	1.3
	ABB IRB 1600				
TRMRS00.008	ABB IRB 6620	no	200	/	2.6
	ABB IRB 6640				
	ABB IRB 6650				
	ABB IRB 6600				
	ABB IRB 6700				
	FANUC R-2000iC/210L				
	KUKA KR210-R3100				
	KUKA KR120				
TRMRS00.009	KUKA KR90	no	140	/	2.4
	KUKA KR120				
	KUKA KR150				
	KUKA KR160				
TRMRS00.010	FANUC M-900iA/400L	no	314	/	4.4
TRMRS00.011	EPSON C8-A1401S	no	/	/	1.2
TRMRS00.012	KUKA KR40PA	no	125	/	1.9
	COMAU NJ-40				
	COMAU NJ-60				
	ABB IRB 4600 40 / 45 / 60				
TRMRS00.013	COMAU NJ-110	no	150	/	2.4
TRMRS00.014	COMAU NS-16	no	82	/	1.4
TRMRS00.015	KAWASAKI RS30N / 50N / 80N	no	133	/	1.5
TRMRS00.016	YASKAWA GP180	no	160	/	2.7
TRMRS00.017	ABB IRB 7600-400	no	250	/	3.4
TRMRS00.018	KAWASAKI RS015X	no	75	/	1.4
TRMRS00.019	FANUC M20iD	no	56	/	1.1
TRMRS00.020	KUKA KR50 / KR70	yes	125	122	1.4
TRMRS00.021	FANUC R-1000iA/80F	yes	125	121	1.4
TRMRS00.022	ABB IRB 8700	no	315	/	4
TRMRS00.023	COMAU NJ-16	no	100	/	1.3
TRMRS00.024	YASKAWA GP225	no	180	/	2.7
	EFORT ER150-3200				
	EFORT ER210-2700				
TRMRS00.025	FANUC M-2000iA900L	no	400	/	5.5
TRMRS00.026	COMAU SMART-5 PAL 470-3.1	no	230	/	3

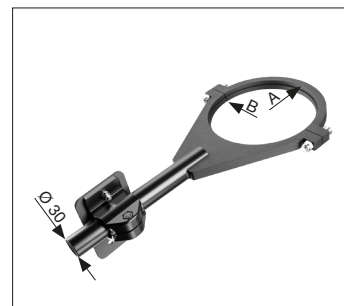

**Input data for robot dresspack enquiry**

**Routing of Utilities**

R  L

**MRS**  
(from axis 3 to axis 6)

YES  NO

YES  NO  
**Tennis Racket**  
(fixing on axis 6)

**Stationary Side**  
(from axis 1 to axis 3)

YES  NO

**Circular Chain**  
(axis 1)

YES  NO  Indicate degrees of rotation

**Robot OEM**

**Robot model**

**MRS/Conduits size**

**Application/ Environment**

# APPLICATIONS

## DRESSPACK SYSTEM FOR ROBOT





# APPLICATIONS

## DRESSPACK SYSTEM FOR ROBOT





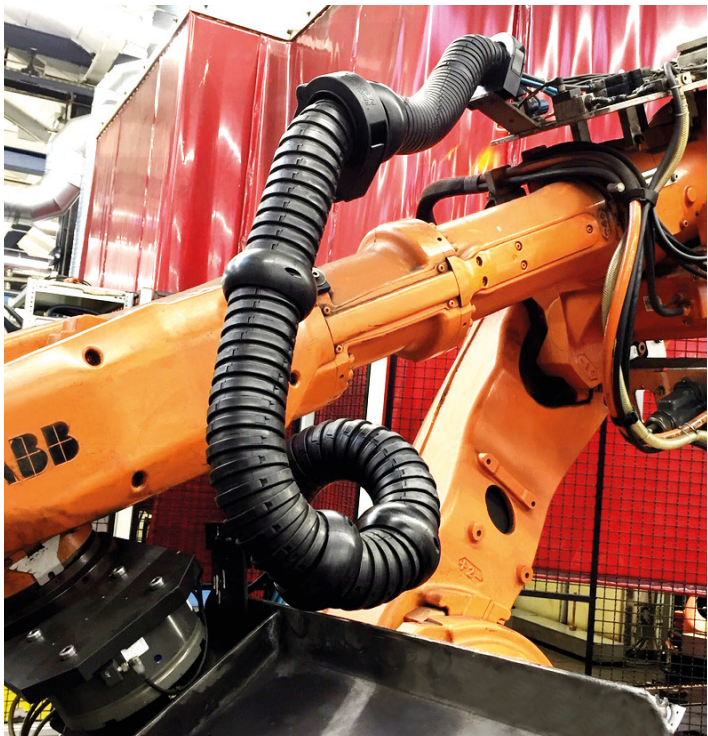



**Brevetti Stendalto S.p.A.**

Viale G.B. Stucchi 66/8  
20900 Monza (MB)

**Tel.** +39 039 204901

**Fax** +39 039 834250

info@brevettistendalto.it  
www.brevettistendalto.it



**Brevetti Stendalto**  
worldwide