

# MFC65100

## MULTIFLEX chain for 3D movements with opening frames

Chain for multi-axis movement, for application on robots and new-generation work centers, fully-enclosed, with opening frames.

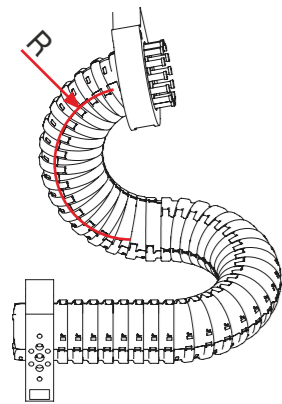
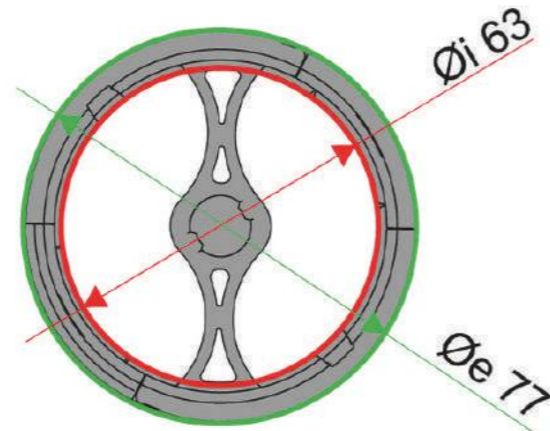

Inner diameter mm	Outer diameter mm	Minimum bend radius mm	Pitch mm	No. of links per meter	Weight kg/m	Torsion per meter	Lodged utilities
63	77	100	18.5	54	1.6	± 540°	max. Ø 20 mm

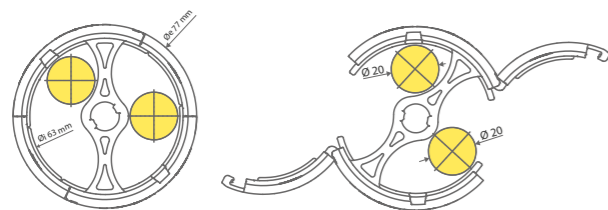

4

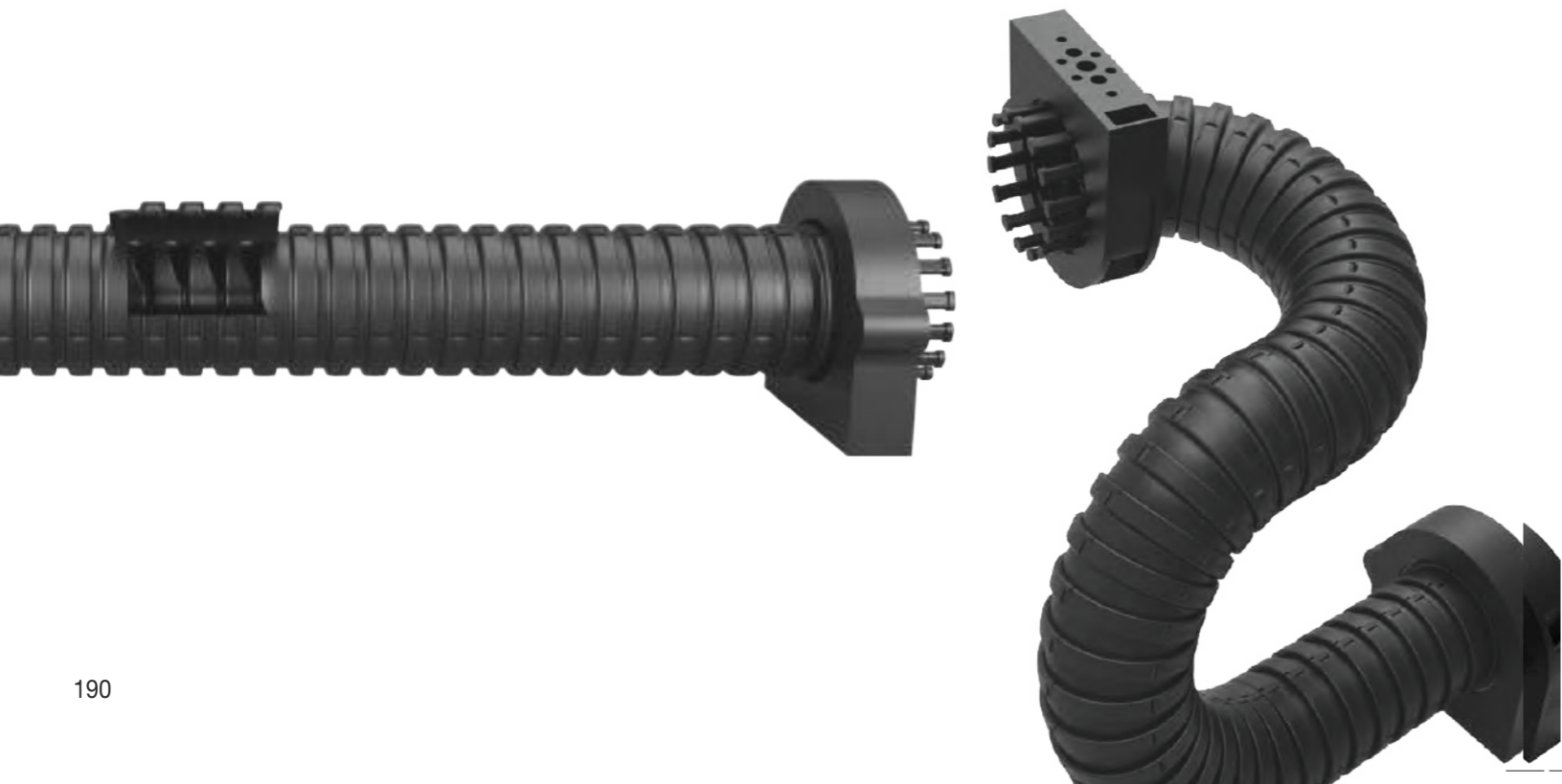

### Fixation accessories

#### Fixation brackets with clamping combs

Standard bracket set with clamping combs. This product is used at the extremities of MULTIFLEX chain.

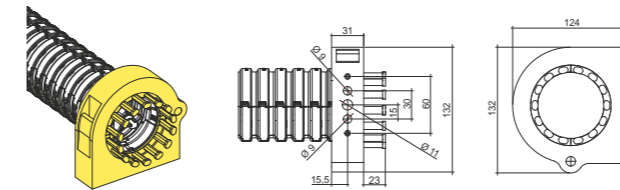

Type of latch	Part No.
Nylon	AMF65K01
Zinc-plated steel	AMF65M01

#### Fixation brackets with clamping combs Frontal fixation

Standard bracket set with clamping combs, for frontal fixation. This product is used at the extremities of MULTIFLEX chain.

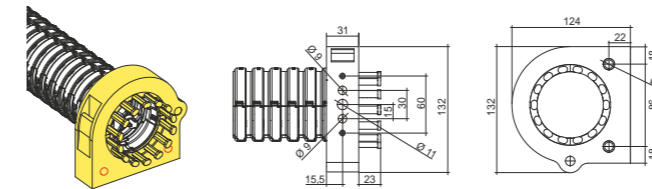

Type of latch	Part No.
Nylon	AMF65K01F
Zinc-plated steel	AMF65M01F

#### End and intermediate fixation brackets

Standard bracket set without clamping combs. This product can be used anywhere on MULTIFLEX chain.

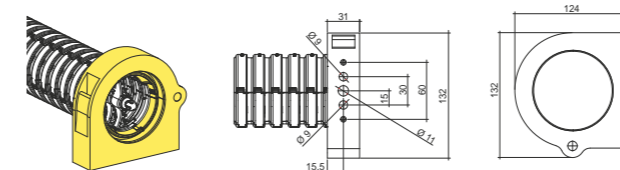

Type of latch	Part No.
Nylon	AMF65K02
Zinc-plated steel	AMF65M02

#### End and intermediate fixation brackets Frontal fixation

Standard bracket set without clamping combs, for frontal fixation. This product can be used anywhere on MULTIFLEX chain.

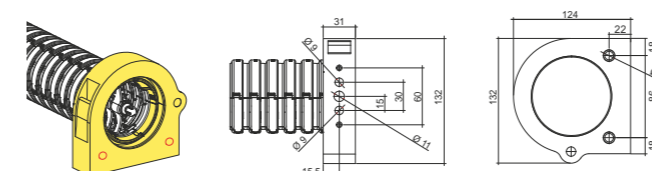

Type of latch	Part No.
Nylon	AMF65K02F
Zinc-plated steel	AMF65M02F

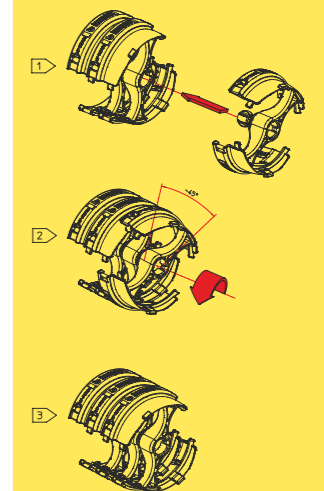

Assembly instructions

4

# MFC65100

## MULTIFLEX chain for 3D movements with opening frames

### Protection and guiding accessories

#### Sliding fixation brackets

Sliding bracket set.

This product can be used anywhere on MULTIFLEX chain.

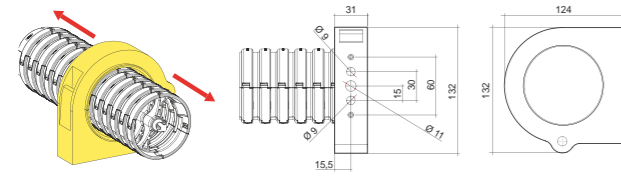

Type of latch	Part No.
Nylon	AMF65K03
Zinc-plated steel	AMF65M03

#### Sliding fixation brackets Frontal fixation

Sliding bracket set, for frontal fixation.

This product can be used anywhere on MULTIFLEX chain.

4

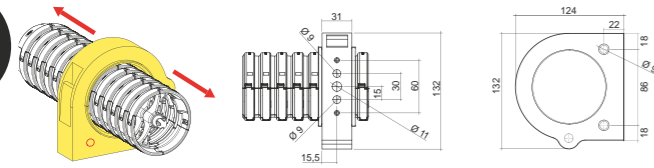

Type of latch	Part No.
Nylon	AMF65K03F
Zinc-plated steel	AMF65M03F

#### Oscillating guiding support with ring

Allows to guide passage of chain, maintaining all degrees of liberty of movement.

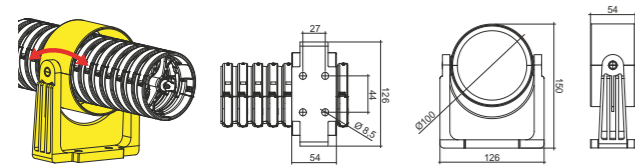

Part No.
ASO65

#### Protection ring

Bumper and rotating protection against hard shocks and extreme friction.

This product can be used anywhere on MULTIFLEX chain.

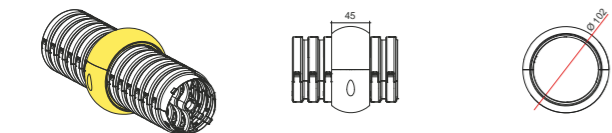

Part No.
PCM65

#### Rotating base

Universal rotating flange, usable with any fixation device. Allows rotation of fixation brackets and pivoting forks.

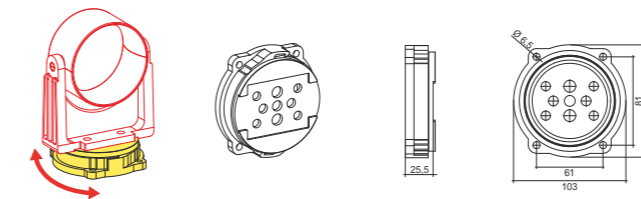

Part No.
PADFB-70

#### Connection jaw

Connector between MULTIFLEX chain and corrugated sheath NW70, or between chain and multi-holed rubber seal. To combine with one fixation brackets type PASSB-70K or PASSB-70M.

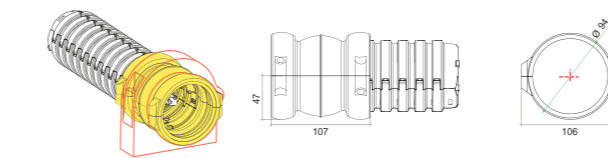

Part No.
PAVGB-70/8529

#### Fixation bracket

To combine with Part No. PAGB-70/8529.

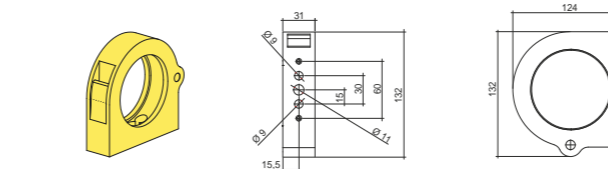

Type of latch	Part No.
Nylon	PASSB-70K
Zinc-plated steel	PASSB-70M

#### Connection ring

Connector between MULTIFLEX chain and corrugated sheath NW70.

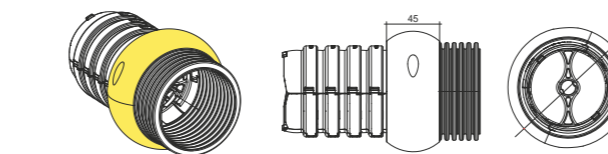

Part No.
GJM65

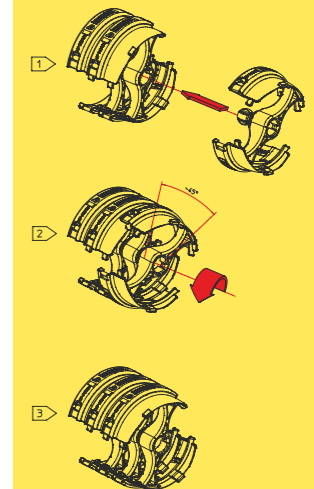

Assembly instructions

4

# MFC65100

## MULTIFLEX chain for 3D movements with opening frames

### Rubber seals and end caps

#### Holed end rubber seals

Multi-hole rubber seal  $\varnothing$  14 mm (4x) -  $\varnothing$  20 mm (4x)

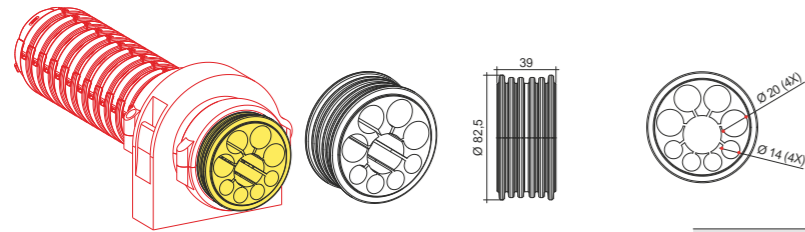

Part No.  
TKKSB-70B01

#### Holed end rubber seals

Multi-hole rubber seal  $\varnothing$  7.5 mm (1x) -  $\varnothing$  10 mm (1x) -  $\varnothing$  12.5 mm (2x) -  $\varnothing$  20 mm (4x)

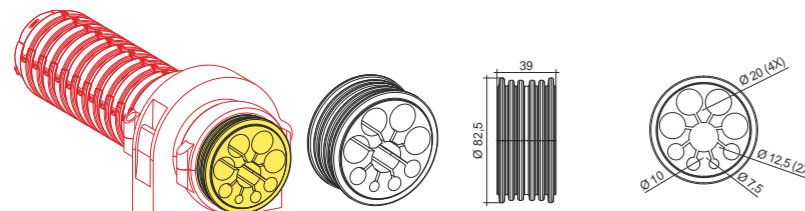

Part No.  
TKKSB-70B02

#### Holed end rubber seals

Multi-hole rubber seal  $\varnothing$  12.5 mm (1x) -  $\varnothing$  14 mm (1x) -  $\varnothing$  15.5 mm (2x) -  $\varnothing$  20 mm (3x)

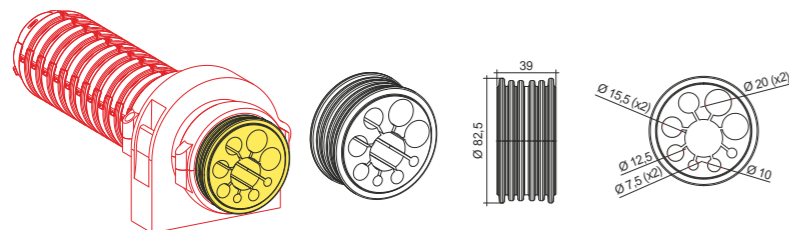

Part No.  
TKKSB-70B03

#### Holed end rubber seals

Multi-hole rubber seal  $\varnothing$  7.5 mm (2x) -  $\varnothing$  10 mm (1x) -  $\varnothing$  12.5 mm (1x) -  $\varnothing$  15.5 mm (1x) -  $\varnothing$  20 mm (2x)

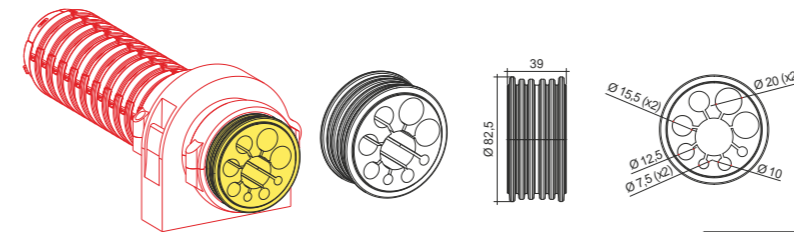

Part No.  
TKKSB-70B04

#### Holed end rubber seals

Multi-hole rubber seal  $\varnothing$  12.5 mm (1x) -  $\varnothing$  14 mm (2x) -  $\varnothing$  17 mm (1x) -  $\varnothing$  18 mm (3x) -  $\varnothing$  19 mm (1x)

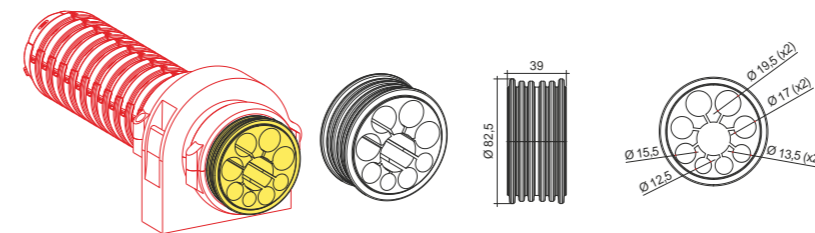

Part No.  
TKKSB-70B05

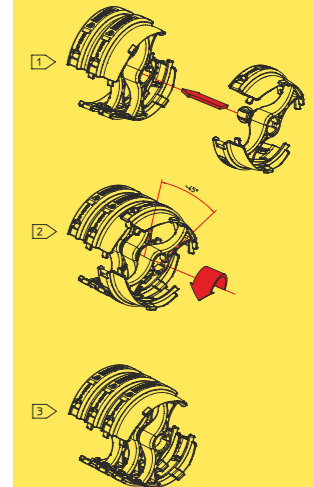

Assembly instructions

# MFC65100

## MULTIFLEX chain for 3D movements with opening frames

### Holed end rubber seals

Multi-hole rubber seal Ø 12.5 mm (1x) - Ø 15.5 mm (2x) - Ø 14 mm (1x) - Ø 20 mm (4x)

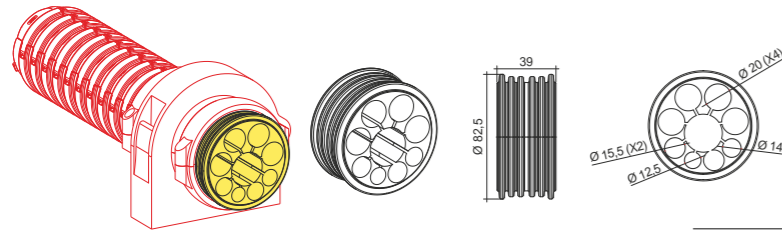

<b>Part No.</b>
<b>TKKSB-70B07</b>

### Blind end rubber seal

4

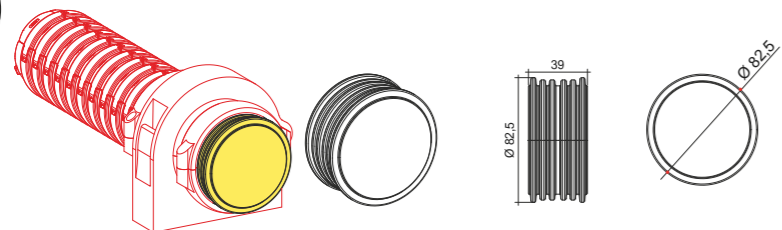

<b>Part No.</b>
<b>TKKSB70BLIND</b>

### End caps

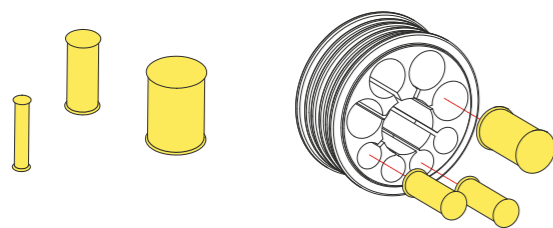

<b>Part No.</b>	<b>Item No.</b>
Cap Ø	
Ø 10 mm	<b>TKBSB-10</b>
Ø 12.5 mm	<b>TKBSB-12.5</b>
Ø 14 mm	<b>TKBSB-14</b>
Ø 15.5 mm	<b>TKBSB-15.5</b>
Ø 19.5 mm	<b>TKBSB-19.5</b>

### Kevlar protective coat

#### Non-opening Kevlar protective coat for dynamic applications

Coat made of Kevlar aramidic fiber on one side; the other side features an aluminum layer in relief that covers the outer surface and reflects up to 95% of thermal radiations. Protects against weld spurts up to 540 °C. Kevlar tissue offers good resistance to oils, greases, acids, bases, and solvents in low concentration. The reflecting surface offers good resistance to UV rays as well.

#### Technical data

Thickness: 0.35 mm  
 Specific weight: 1.44 / 1.45 g/cm<sup>3</sup>  
 Pulling resistance: 2500 N/50 mm  
 Flammability: non-flammable (up to DIN 4102B1)

<b>Part No.</b>	<b>Item No.</b>
Length	
500 mm	<b>KA04S08005</b>
1000 mm	<b>KA04S08010</b>
1500 mm	<b>KA04S08015</b>
2000 mm	<b>KA04S08020</b>

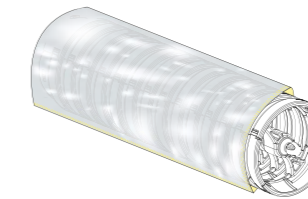

#### Velcro opening Kevlar protective coat for static applications

Coat made of Kevlar aramidic fiber on one side; the other side features an aluminum layer in relief that covers the outer surface and reflects up to 95% of thermal radiations. Protects against weld spurts up to 540 °C. Kevlar tissue offers good resistance to oils, greases, acids, bases, and solvents in low concentration. The reflecting surface offers good resistance to UV rays as well.

#### Technical data

Thickness: 0.35 mm  
 Specific weight: 1.44 / 1.45 g/cm<sup>3</sup>  
 Pulling resistance: 2500 N/50 mm  
 Flammability: non-flammable (up to DIN 4102B1)

<b>Part No.</b>	<b>Item No.</b>
Length	
500 mm	<b>KA04S080G05</b>
1000 mm	<b>KA04S080G10</b>
1500 mm	<b>KA04S080G15</b>
2000 mm	<b>KA04S080G20</b>

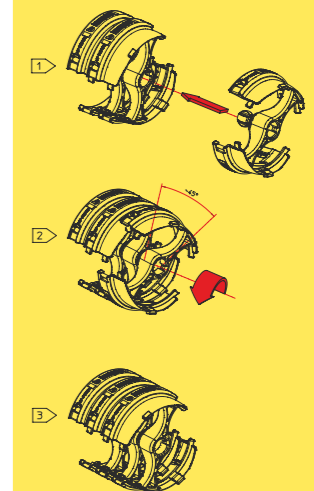
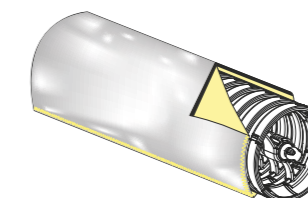

Assembly instructions

4