

445PS

Nylon Protection Cable Chain with opening covers

Inner height (D) 41 mm

Sideband construction with anti-friction sigle-pin.

Covers openable only inner radius. Vertical separator system are available.

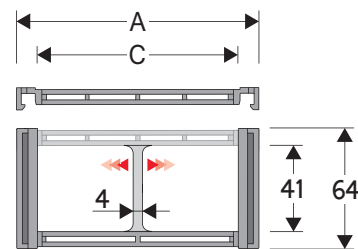

Separator

- Unassembled Part.no S445CNF
- Assembled Part.no S445CNFMC

Pin

Part.no PG445

Technical characteristics when self-supported

Speed	10 m/s
Acceleration	50 m/s ²

For higher requirements please consult our technical dept.

A	B	C	D	R	Weight/m	Chain
mm	mm	mm	mm	mm	kg	Part Number
83	64	61	41	100-125-150-175-200-250-300	1,87	445PS061 □□□ *
97	64	75	41	100-125-150-175-200-250-300	2,05	445PS075 □□□ *
147	64	125	41	100-125-150-175-200-250-300	2,49	445PS125 □□□ *

*Complete the code by inserting the value of the radius (R): Ex. Es. 445PS061 □□□ □□

R	H	N	M	N1	M1
mm	mm	mm	mm	mm	mm
100	264	200	450	340	740
125	314	225	530	460	1020
150	364	250	605	580	1300
175	414	275	685	700	1575
200	464	300	765	820	1855
250	564	350	920	1055	2410
300	664	400	1080	1295	2970

For sliding applications, characteristics techniques may vary depending on the frequency, added weight and work environment.

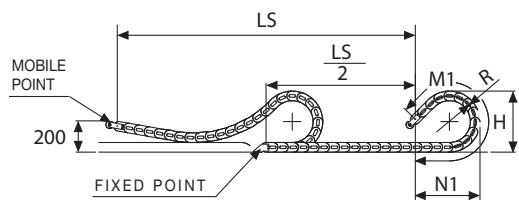
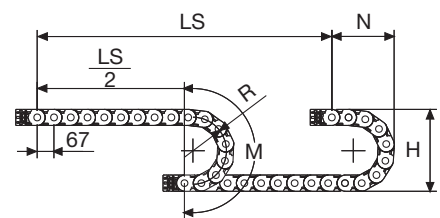

SLIDING VERSION
to be ordered with pivoting end brackets set

Length of chain (L)

Half travel distance ($\frac{LS}{2}$)

plus length of curve (M) or (M1)

$$L = \frac{LS}{2} + M \text{ or } M1$$



Self-Supporting Capacity Diagram

The maximum length of the self-supporting capacity ($\frac{LS}{2}$) in relationship to the weight of the cables and hoses contained per linear metre.

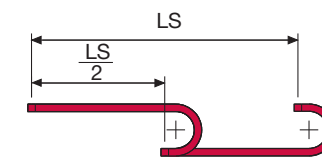
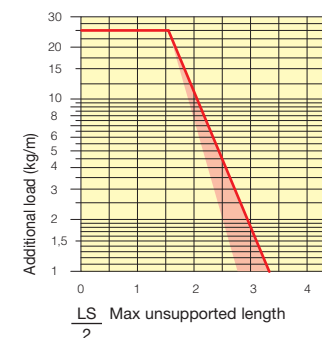

The red marking in the diagram area considers the difference of weight between various widths of chain.

For applications with $\frac{LS}{2}$ and weights not included in the area of the diagram showing self-supporting capacity, verify the possible use of support rollers (see page 30).

END-BRACKETS for SLIDING



Nylon Type Part Numbers

Complete Set Assembled
AWB445PS□□□□*KM□**

Complete Set Unassembled
AWB445PS□□□□*K

* Inner width (C)

** 1=Pos.1; 2=Pos.2

Fixed point end brackets see Fig.A

Movable point end brackets see Fig.B

End Brackets

The end brackets set allows the two ends of the chain to be attached to the equipment. Set complete with tiewrap clamps available on request.

Nylon version

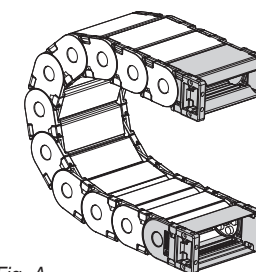

Fig. A
The chain can be fixed frontally, inner or outer radius. (Fig A)

Nylon version

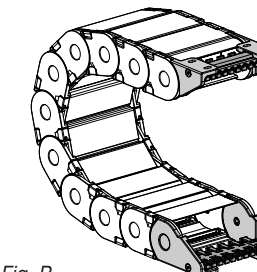
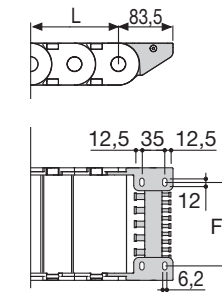
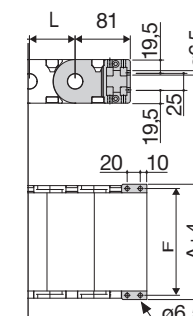

Fig. B
Chain fixed outside the radius. (Fig B)
See end brackets mounting variations page 31.



Chain type	F mm
445PS 061	74
445PS 075	88
445PS 125	138

Nylon Type Part Numbers

Complete Set Assembled
AW445PS□□□□*KM

Complete Set Unassembled
AW445PS□□□□*K

* Inner width (C)

Chain type	F mm
445PS 061	39
445PS 075	53
445PS 125	103

Nylon Type Part Numbers

Complete Set Assembled
AN445PSKM□**

Complete Set Unassembled
AN445PSK (for pos.1,2,3)

AN445PSK□*** (for pos.5,6)

Tiewrap Clamp Part Number

Complete Set Assembled
SFCT445□□□*KM

Complete Set Unassembled
SFCT445□□□*K

* Inner width (C)

** 1=Pos.1; 2=Pos.2; 3=Pos.3

5=Pos.5; 6=Pos.6

*** 5=Pos.5; 6=Pos.6

445PS Nylon Protection Cable Chain with opening covers

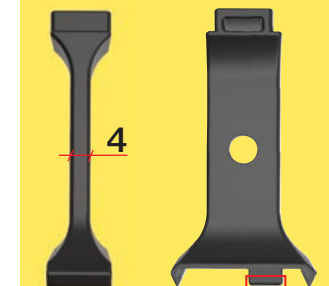

S445CNF

This separator can be mounted in 2 ways different ensuring the same reliable resistance.



mounted outside the premises the separator can move



mounted inside the seats assumes a fixed position.

For further information please consult Brevetti Standalto's Technical Office