

## 250L/LI/LE Nylon Cable Chain

### Inner height (D) 17 mm

Single link construction.  
Non-opening version (250L).  
Version with opening frames from inner radius (250LI) or from outer radius (250LE).  
Vertical separators available.

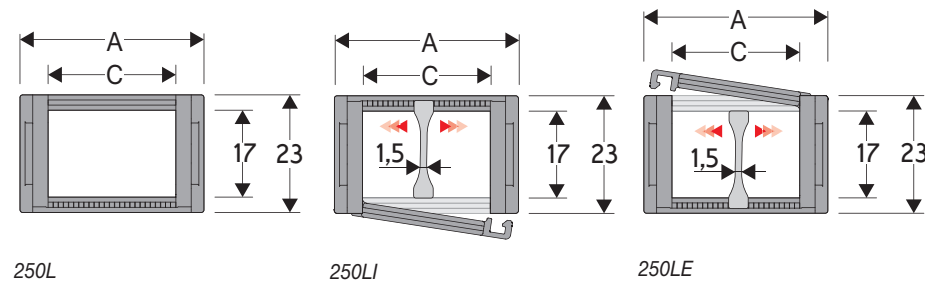

### Separator

- Unassembled	Part.no S250L
- Assembled	Part.no S250LMC

### Technical characteristics when self-supported

Speed	10 m/s
Acceleration	50 m/s <sup>2</sup>

For higher requirements please consult our technical dept.

For sliding applications, technical data can slightly change according to frequency, added weight and environment.

**SLIDING VERSION**  
to be ordered with pivoting end brackets set

A	B	C	D	R	Weight/m	Chain
mm	mm	mm	mm	mm	kg	Part Number
26	23	15	17	028-038-045-060-075-100	0,34	250L(LI)(LE)015 □□□ *
36	23	25	17	028-038-045-060-075-100	0,37	250L(LI)(LE)025 □□□ *
46	23	35	17	028-038-045-060-075-100	0,40	250L(LI)(LE)035 □□□ *
61	23	50	17	028-038-045-060-075-100	0,43	250L(LI)(LE)050 □□□ *

\*Complete the code by inserting the value of the radius (R): Ex. 250L035□□□□

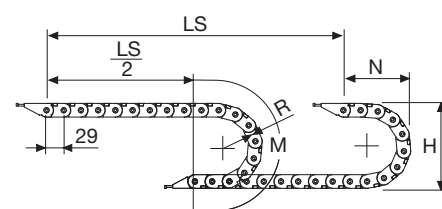

R	H	N	M	N1	M1
mm	mm	mm	mm	mm	mm
028	79	68,5	146	120	255
038	99	78,5	177	125	270
045	113	85,5	199	250	530
060	143	100,5	246	400	850
075	173	115,5	294	505	1085
100	223	140,5	372	650	1405

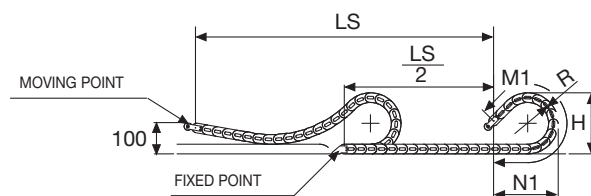

Length of chain (L)  
Half travel distance ( $\frac{LS}{2}$ )  
plus length of curve (M) o (M1)

$$L = \frac{LS}{2} + M \text{ o } M1$$

### 250L

Non-opening  
Sliding



### 250LI

Frames opening from inner radius  
No Sliding



### 250LE

Frames opening from outer radius  
No Sliding



### Self-Supporting Capacity Diagram

The maximum length of the self-supporting capacity ( $\frac{LS}{2}$ ) in relationship to the weight of the cables and hoses contained per linear metre.

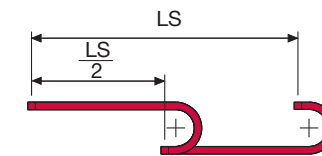
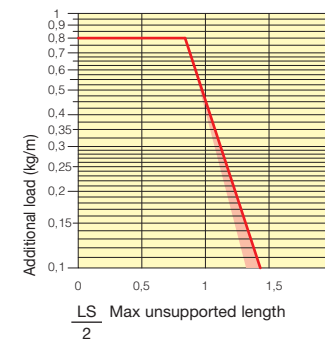

The red marking in the diagram area considers the difference of weight between various widths of chain.

For applications with  $\frac{LS}{2}$  and weights not included in the area of the diagram showing self-supporting capacity, verify the possible use of support rollers (see page 30).

### End Brackets

The end brackets set allows the two ends of the chain to be attached to the equipment. End brackets are equipped with tie-wrap clamps.

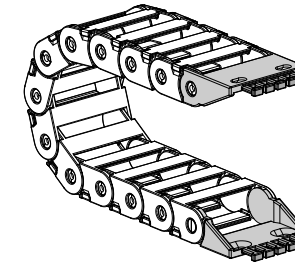
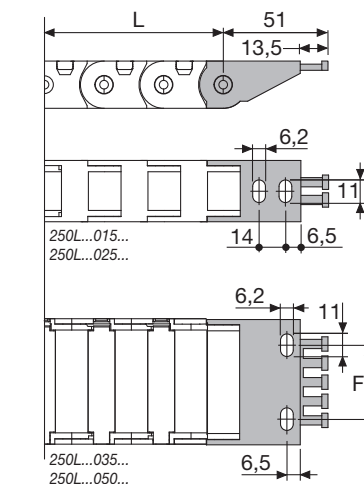

Fig. A  
Chain fixed outside the radius. (Fig A)  
See end brackets mounting variations page 31.



Chain Type	F mm
250L...035...	21
250L...050...	36

### Nylon Type Part Numbers

Complete Set Assembled	
Chain Type	End Brackets Set
250L	AN250L□□□*KM□**
Complete Set Unassembled	
Chain Type	End Brackets Set
250L	AN250L□□□*K□**

\* Inner width (C)  
\*\* 1=Pos.1; 2=Pos.2; 3=Pos.3  
5=Pos.5; 6=Pos.6

## 250L 250LI 250LE Nylon Cable Chain

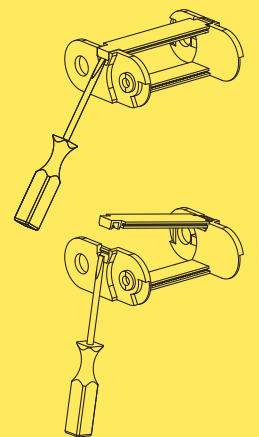

How to open the cover.

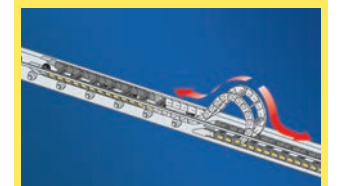

250L version only suitable to long travel distance. To choose the guide channel see page 58

For further information please consult Brevetti Stendalto's Technical Office